

EST. 1998

LEGACY CRAFTED CABINETS

Style Guide



INTRODUCING

JUNO

NOW AVAILABLE

Shown in Gale Force O-M-C

Door Selection Guide

The Process of Legacy...One job at a time. Individually Crafted.



CORTLAND O-M-C

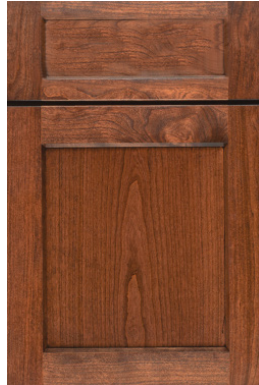

MILTON O-M-C

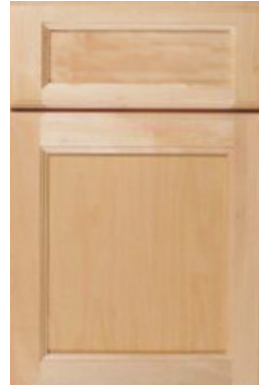

MIFFLIN O-M-C



DENTON O-M-C



ASTORIA M-C



HAMILTON O-M-C-H



CALDWELL O-M-C-H



PAYTON O-M-C



ESSEX O-M-C



WINFIELD O-M-C



AVALON O-M-C-H



JUNO O-M-C



CHELSEA* O-M-C



HAYWOOD* O-M-C



DUVAL* O-M-C-H



GRIFFIN* O-M-C-H

*Traditional Overlay Only

O=Oak, M=Maple, C=Cherry, H=Hickory

– Standard Stains –



– Standard Paints –



– Optional Premium Finishes –

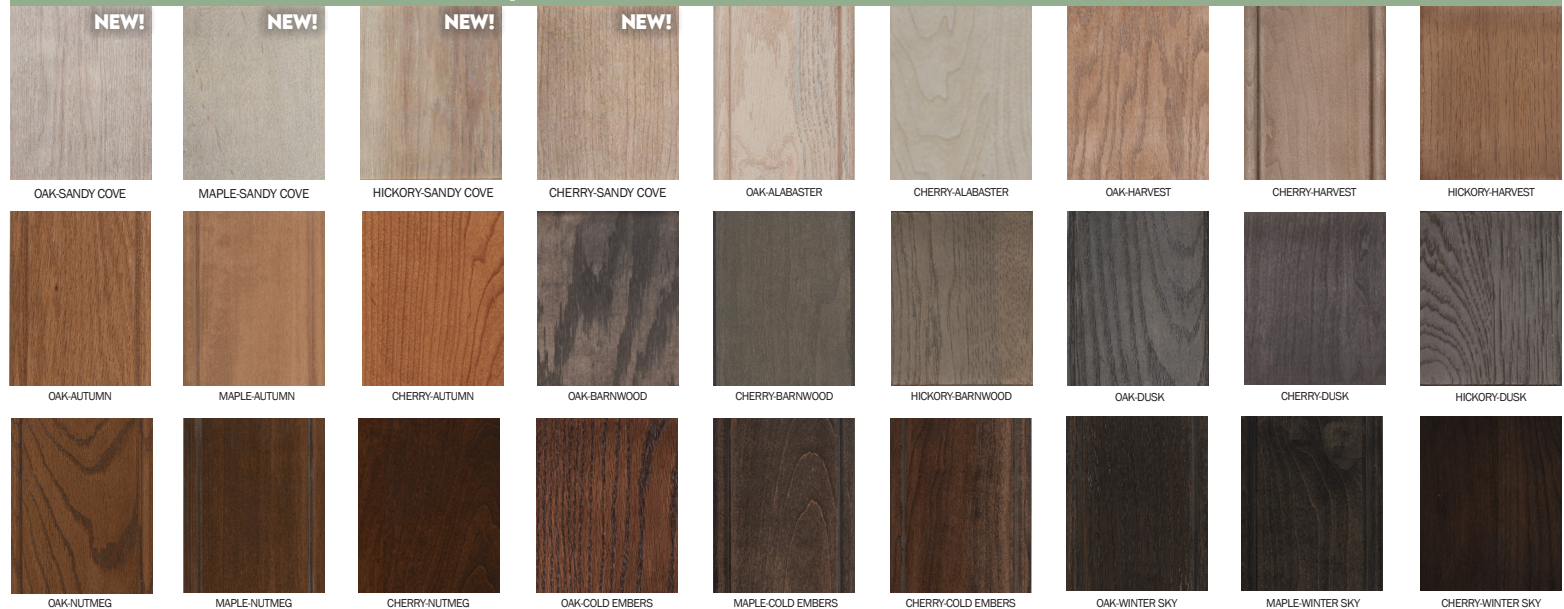

— Knotty Hickory/Cherry —

Legacy Crafted Cabinets "Knotty" grade was developed to provide our customers with a material that allows knots, split knots, ingrown bark, character marks and other natural characteristics.

Winfield Cherry



Caldwell Cherry



Caldwell Hickory



Essex Cherry



Griffin Hickory



Legacy Crafted Cabinet Construction

All of our cabinets feature:

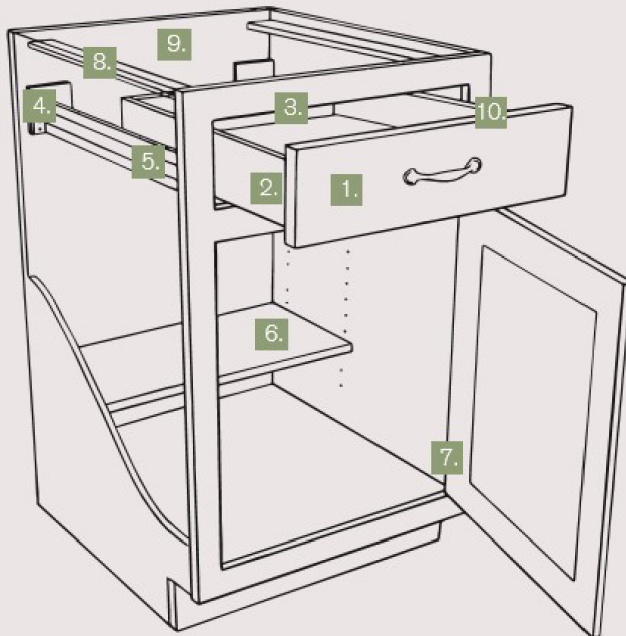

1. Solid wood face frame & drawer boxes
2. 5/8" thick dovetail drawer construction
3. Full-depth drawer construction
4. 100 lb. static under-mount drawer glides
5. Soft-close full extension drawers
6. 3/4" thick adjustable shelving
7. 6-way soft-close adjustable hinges
8. 3/4" thick full-depth plywood I-beam dadoed into sides and face frame
9. 1/4" back panel with 1/2" nailer
10. 1/2" side panels



Connect With Us!



legacycrafted.com

